

This unit must be installed by a qualified electrician in accordance with the latest edition of the IET wiring regulations BS7671. The enclosure should be installed on a flat vertical wall, and must be earthed. To maintain the ingress protection rating of the enclosure, suitable cable entry glands must be

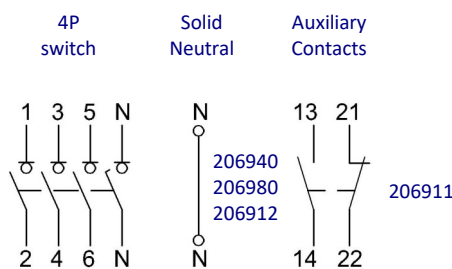

Rated Operational Current & Power					
Ith	Ue	AC-21A/B	AC-22A/B	AC-23A/B	
32A	415V	32A	32A	32A	15kW
	500V	32A	32A	25A	15kW
	690V	32A	32A	25A	15kW
63A	415V	63A	63A	63A	30kW
	500V	63A	63A	63A	30kW
	690V	63A	63A	40A	30kW
80A	415V	80A	80A	80A	37kW
	500V	80A	80A	63A	37kW
	690V	80A	80A	40A	37kW
100A	415V	100A	100A	100A	45kW
	500V	100A	100A	80A	45kW
	690V	100A	100A	63A	45kW
125A	415V	125A	125A	125A	55kW
	500V	125A	125A	100A	55kW
	690V	125A	125A	63A	55kW

Technical Data	
Reference standard	IEC60947-3
Rated operational voltage (Ue)	690Vac
Rated current (Ith/Ie) ≤40°C	32 / 63 / 80 / 100 / 125A
Rated frequency (Fn)	50/60Hz
Rated insulation voltage (Ui)	800V ac
Rated impulse withstand voltage (Uimp)	8kV
Insulation Class	I
Rated conditional short circuit current (I _p) r.m.s 415Vac	32A: 10kA 63-80A: 15kA 100-125A: 20kA
Rated short time withstand current (I _{cw}) r.m.s 690V / 1 second	32A: 1000A 63-80A: 1500A 100-125A: 2500A
Rated short circuit making capacity (I _{cm}) 690V	32A: 800A 63-80A: 1400A 100-125A: 2100A
Rated breaking capacity	8x I _e
Switch terminal capacity line/load (min/max)	32A: 0.75-10mm ² 63-80A: 1.5-35mm ² 100-125A: 10-70mm ²
Suggested cable capacity line/load (min/max) for enclosed switches	32A: 0.75-10mm ² 63-80A: 1.5-25mm ² 100-125A: 10-50mm ²
Terminal tightening torque	32A: 1.2Nm 63-80A: 3Nm 100-125A: 8Nm
Ingress protection rating EN60529	IP65
Operating temperature	-25 to +55°C
Derating factor ≥40°C	20%
Storage temperature	-40 to +70°C
Enclosure material	Mild steel
Enclosure finish colour	RAL7035
Enclosure door locking—quarter turn	Double bar lock
Mechanical interlock with door	ON position only
Pad lockable	OFF position only



The switch can be pad locked in the OFF position by up to three padlocks with shackle diameters up to

Isolators may be fitted with a maximum of two add on auxiliary contact blocks (type 206911), on the left hand side of the switch.

- Loosen the centre screw on the green /yellow earth terminal
- Slide it to the left to provide access to the switch body.
- Align the 2 fixing clips on the add on block with the corresponding holes on the switch body
- Rotate the add on block towards the upright position
- Press down the actuator on the add on block
- Lock into place
- Reposition the earth terminal and securely fasten the centre screw

To release an add on block, press and hold the locking tab located on the front face of the block (see picture 7), away from the main switch body.

The switched neutral pole (on the right hand side of the switch assembly) can be exchanged for an alternative neutral pole with solid unswitched connection, using the same method as detailed above for fixing / releasing of add on blocks.

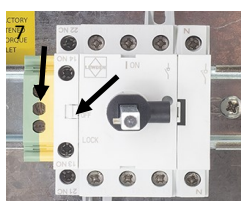
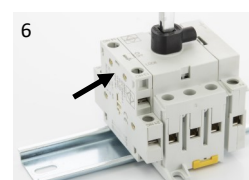
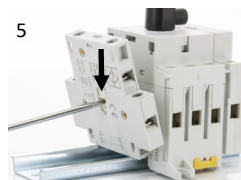
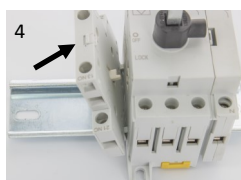
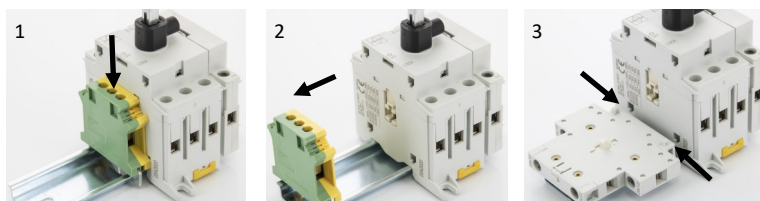

Auxiliary contacts				
Part No	Config.	Parameters	Ui	Uimp
206911	1NO+1NC	AC-13: 10A 230V~ AC-15: 6A 230V~	600V	6kV

Ordering Codes				
Switch Part Number	Switch Rating	Unswitched Neutral Pole (optional)	Neutral Pole Rating	Auxiliary Contact 1NO + 1NC
IS324P	32A	206940	40A	206911
IS634P	63A	206980	80A	
IS804P	80A			
IS1004P	100A	206912	125A	
IS1254P	125A			