

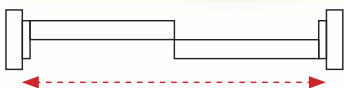

The Electricians' Choice

SLIDE
AND LINK
TOGETHER
EASILY



100A DISTRIBUTION TERMINAL BLOCKS

- > Designed to ensure safe terminations for any application with the ease of installation and maintenance.
- > Provide a neat and aesthetically pleasing appeal to the overall installation.
- > 6 different colour-coded terminals for quick identification of phase, neutral, and earth connections.
- > Modular construction allows for them to be close coupled.
- > Dual cable entry points allow for flexibility in installation.



Scan the QR code
to explore terminal blocks

▲ Distribution Terminal Blocks

Now designed with 3mm Allen screw terminals, simplifying installations by requiring just one 3mm Allen key for all connections.

- 5 Way Single Pole Distribution Terminal Blocks - 100A <690VAC.
- Can accept up to 5 conductors with a generous cable capacity from 2.5 to 35mm².
- Dual screw terminations to ensure secure and reliable connections.
- Ingress Protection IP20; 960°C glow wire tested.
- Secure cover with wire locking capability.
- Colour coded for easy identification.
- Sold in a box quantity of 5 per colour.



Lewden Part Number	Colours	Dimensions H x W x D (mm)
DT1005BR	Brown (L1)	68 x 50 x 43.5
DT1005BK	Black (L2)	68 x 50 x 43.5
DT1005GY	Grey (L3)	68 x 50 x 43.5
DT1005BL	Blue (N)	68 x 50 x 43.5
DT1005GN	Green (Earth)	68 x 50 x 43.5
DT1005PK	Pink (Functional Earth)	68 x 50 x 43.5

Designed for secure terminations across various applications, offering simplicity in installation and maintenance

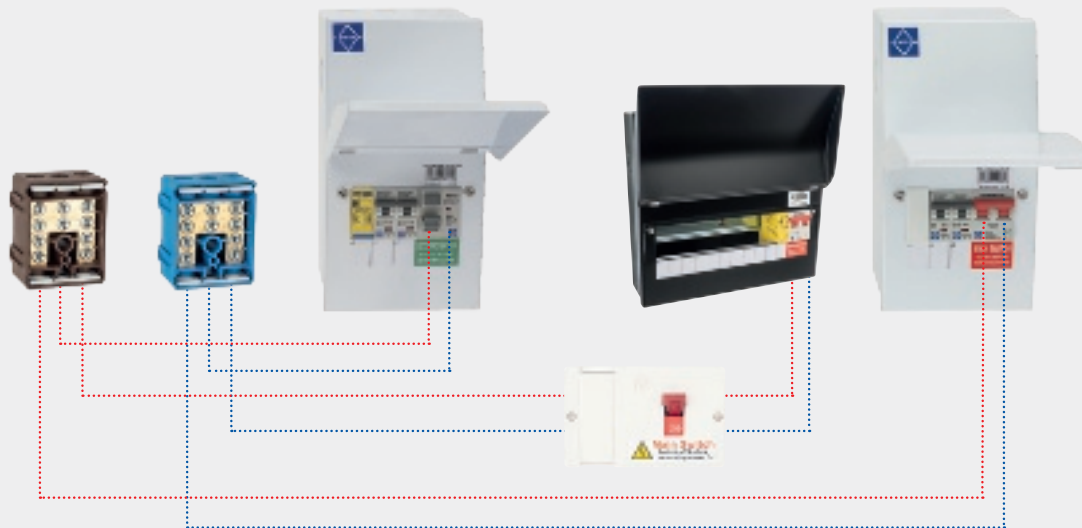

The Electricians' Choice

Tel.: +44 (0) 1376 336 200 | sales@lewden.co.uk | lewden.com



Lewden_Elec



Lewden - Palazzoli Group



Lewden



@lewdenpalazzoli



@lewdenltd